PETITION FOR INCORPORATION OF THE CITY OF MILLCREEK

To the Honorable County Legislative Body of Salt Lake County, Utah:

WE, the undersigned owners of real property within the area described in this Petition, respectfully petition the Salt Lake County Legislative Body to submit to the registered voters residing within the area described in this petition, at a special election held for that purpose, the question of whether the area should incorporate as a city. Each of the undersigned affirms that each has personally signed this Petition and is an owner of real property within the described area, and that the current residence address of each is correctly written after the signer's name. The area proposed to be incorporated as the City of MillCreek is more particularly described in Exhibit "A," attached hereto and incorporated herein by reference, which area is also shown on the Map in Exhibit "A," which has been prepared by a licensed surveyor.

We, the undersigned, hereby designate the following petition signers as the Contact Sponsor and Sponsors for purposes of this Petition.

- Anna Clare Shepherd 2785 Upland Drive, Salt Lake City, Utah 801-277-4579 Contact Sponsor
- Mary Susan Lawrence 2434 East 3225 South, Salt Lake City, Utah 801-466-1844 Sponsor
- Roger A. Livingston 3690 Kimbary Way, Salt Lake City, Utah 801-278-9144 Sponsor
- Dan Lofgren 3618 Wasatch Cove Cir., Salt Lake City, Utah 801-277-9220 Sponsor
- Daniel Marriott 1528 East Fuller Drive, Salt Lake City, Utah 801-274-3667 Sponsor

We, the signers of this Petition, appoint the above-named Sponsors, if the incorporation measure passes, to represent us in the process of (a) selecting the number of commission or council members the new city will have; and (b) drawing district boundaries for the election of commission or council members, if the voters decide to elect commission or council members by district.

<i>Print Signer's Name</i>	<i>Signer's Residence Address</i>	<i>Signature</i>
1. _____	_____	_____

2. _____	_____	_____

3. _____	_____	_____

4. _____	_____	_____

5. _____	_____	_____

6. _____	_____	_____

7. _____	_____	_____

8. _____	_____	_____

9. _____	_____	_____

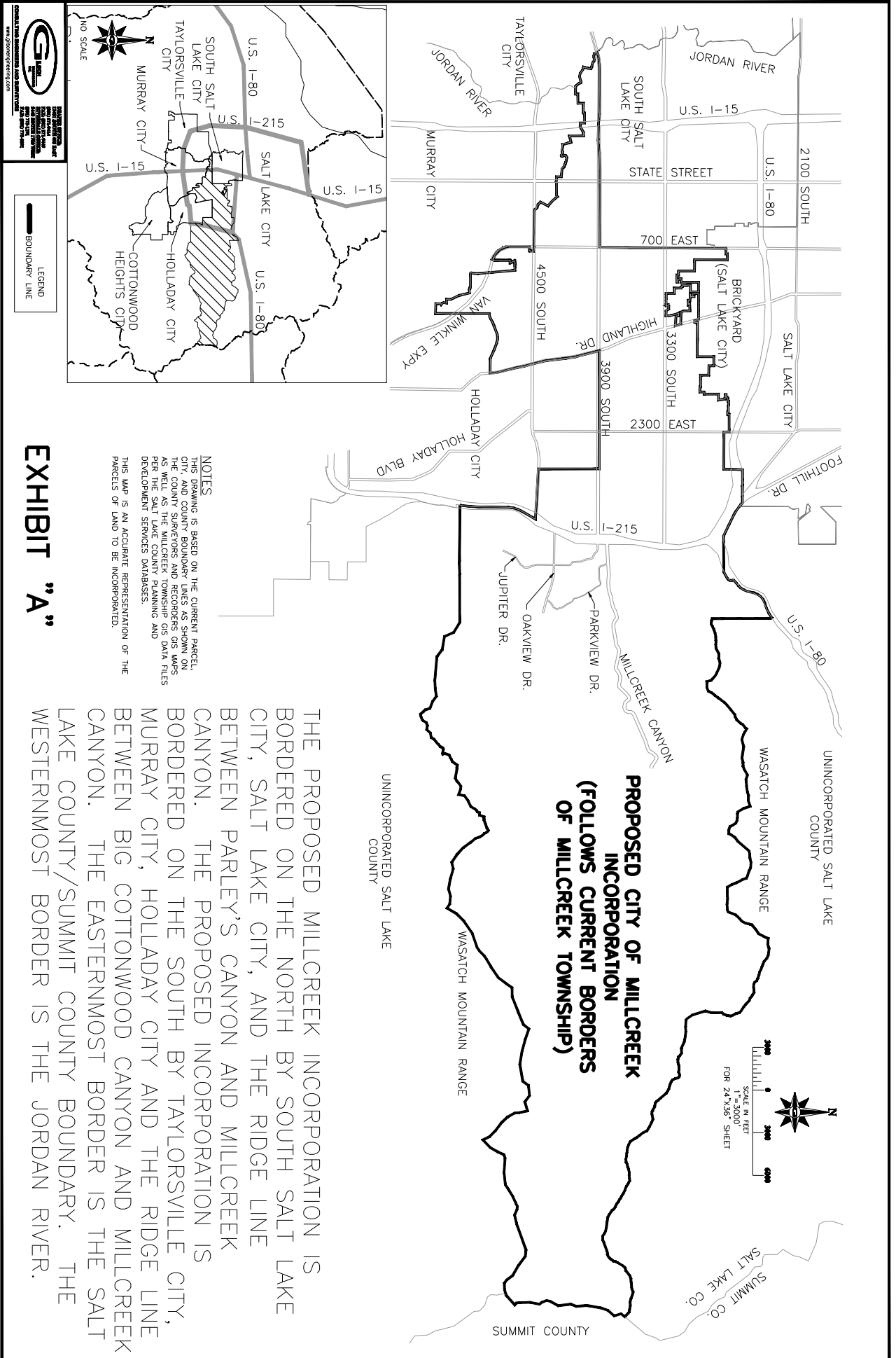

**PROPOSED CITY OF MILLCREEK
INCORPORATION
(FOLLOWS CURRENT BORDERS
OF MILLCREEK TOWNSHIP)**

NOTES
 THIS DRAWING IS BASED ON THE CURRENT PARCEL, CITY, AND COUNTY BOUNDARY LINES AS SHOWN ON THE COUNTY SURVEYS AND RECORDS GIS MAPS PER THE SALT LAKE COUNTY PLANNING AND DEVELOPMENT SERVICES DATABASES.
 THIS MAP IS AN ACCURATE REPRESENTATION OF THE PARCELS OF LAND TO BE INCORPORATED.

EXHIBIT "A"

THE PROPOSED MILLCREEK INCORPORATION IS BORDERED ON THE NORTH BY SOUTH SALT LAKE CITY, SALT LAKE CITY, AND THE RIDGE LINE BETWEEN PARLEY'S CANYON AND MILLCREEK CANYON. THE PROPOSED INCORPORATION IS BORDERED ON THE SOUTH BY TAYLORSVILLE CITY, MURRAY CITY, HOLLADAY CITY AND THE RIDGE LINE BETWEEN BIG COTTONWOOD CANYON AND MILLCREEK CANYON. THE EASTERNMOST BORDER IS THE SALT LAKE COUNTY/SUMMIT COUNTY BOUNDARY. THE WESTERNMOST BORDER IS THE JORDAN RIVER.

ES&S
 ENGINEERING & SURVEYING SERVICES
 1000 WEST 1500 SOUTH
 SALT LAKE CITY, UT 84119
 (801) 466-1111
 www.esandsurvey.com

LEGEND
 BOUNDARY LINE